

Corteco Service Information No. 00031-EN  
[www.corteco.com](http://www.corteco.com) [www.ecatcorteco.com](http://www.ecatcorteco.com)



**Service Information:** **Joint for brake hoses**

**Corteco No** **19018740 - 19018748**



OE-Reference NRC7874; 1520230; 1272002



Make LAND ROVER; FORD



Model -

Engine -

View [www.ecatcorteco.com](http://www.ecatcorteco.com) for detailed information

## Range adaptation

# JOINT DIMENSION CHANGE

Due to the re-engineering of the production line at manufacturer level, the joint "SW16" dimension is no longer available.

Joint SW 16 in brake hoses 19018740 and 19018748 have been replaced with joint SW 15. This insure that the brake hoses have the same characteristics as before.

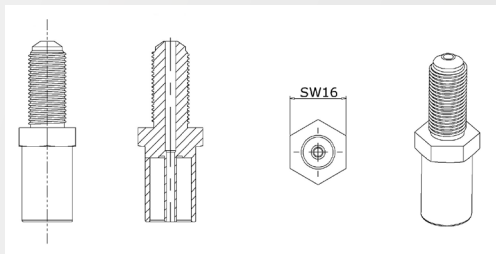

Figure 1: Joint SW16 no longer available

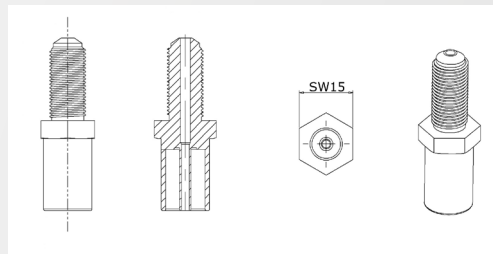
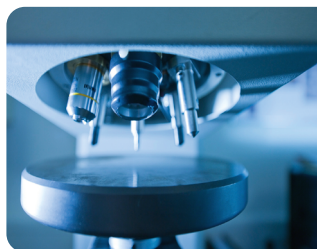

Figure 2: Joint SW15



Specific product design to fulfill OE requirements



High quality raw materials for high-level service parts



Efficient production processes



Global supply chain, dedicated to the aftermarket